

CURVED BENCH

Designer: SPARK - Tom Lauck



SLATS

- Oiled hardwood
- Composite

FRAME

- Hot dip galvanised mild steel

FRAME FINISH

- Galvanised
- Powdercoated

INSTALLATION

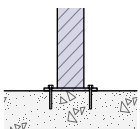

Bolt Down

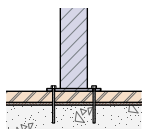

Bolt Through

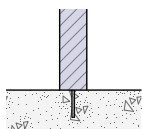

Concealed Fix

FIXINGS

- 12mm fixings for 14mm for Diameter holes

Alternative finishes available on request

WAVE CURVED BENCH

SPECIFICATIONS

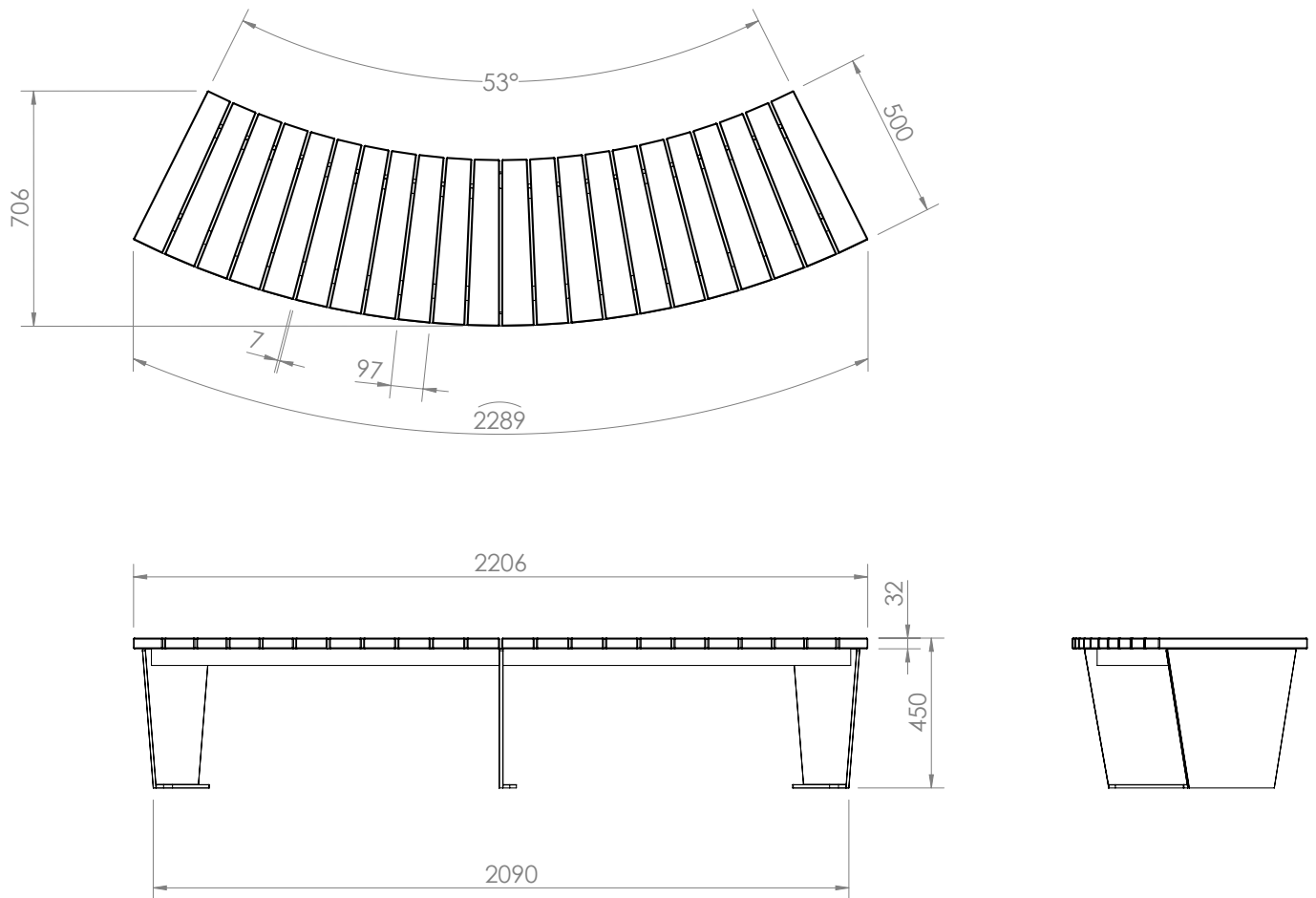

Measurements are in millimetres. Drawings are not to scale.
Dimensions shown are for timber option.

PRODUCT CODE	FRAME FINISH	SLAT OPTIONS & SIZES (mm)
WAV002-HDG-GV-T-22C	Galvanised	125x32 Oiled hardwood timber
WAV002-HDG-GV-C-22C	Galvanised	90x40 Composite
WAV002-HDG-PC-T-22C	Powdercoated	125x32 Oiled hardwood timber
WAV002-HDG-PC-C-22C	Powdercoated	90x40 Composite